

## *Bushing & Insulator*

### Bushing & Insulator

Cast Resin Insulated

Technical Specifications

Type		B630OE	B630SE	B630OA	B630AE	B1700SP	I24,213,C	I24,185,C
Highest voltage for equipment	KV	24	24	24	24	0.72	24	24
Power frequency withstand voltage, 1 minute	KV	50	50	50	50	3	50	50
Lightning impulse voltage (1.2/50 $\mu$ s full wave)	KV	125	125	125	125	----	125	125
Max. primary current	A	630	630	630	630	1700	-----	-----
Max. rated short time thermal current (I <sub>th</sub> ), 1 sec.	KA	40	40	40	40	60	-----	-----
Max. rated dynamic current ( I <sub>dyn</sub> = 2.5×I <sub>th</sub> )	KA	100	100	100	100	150	-----	-----
Dimension	mm	Shown on the diagrams						

# Bushing & Insulator

**B630AE**

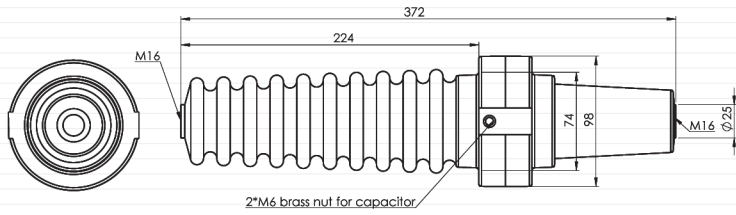

**B1700SP**

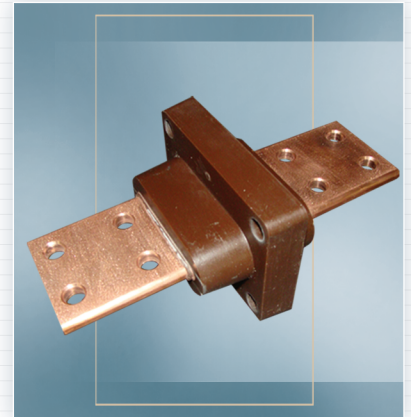
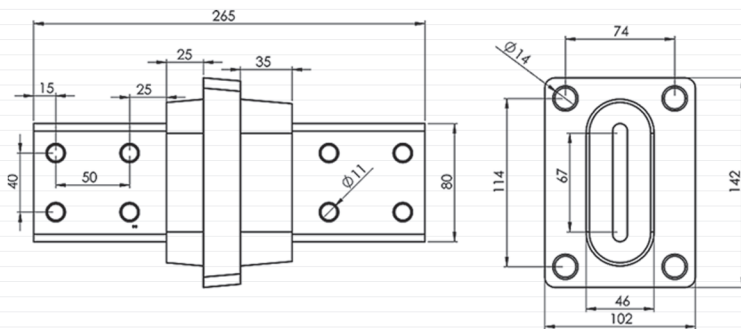

**I24,213,C**

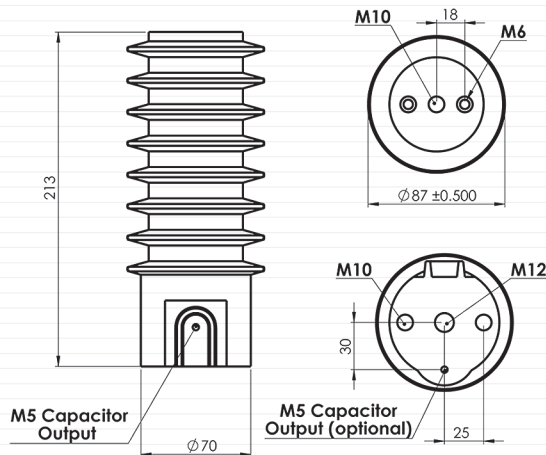

**I24,185,C**

